



RAILWAY

Werther Railway,
trains will fly.



2021

Mobile columns



RAILWAY

BASE

The Group Brands



The BASE Group in Numbers

9
Brands

5
Facilities in Italy,
Germany and France

3
R&D Centres

160
Countries where
BASE operates

600
Employees

180
Million euros in
revenues

13,000
Sq.m of production
area

517
Patents registered

BASE

BASE is a multinational group with 600 employees and revenues of 180 million euros. Thanks to the profound connection between our individual brands, the Group vaunts an array of products, services and combinations thereof, thus offering concrete competitive advancement in the sectors in which it operates: Automotive, Motorcycles, Lorries, Agriculture, Railways.

WERTHER

WERTHER INTERNATIONAL has been operating in the lifting sector since 1972. It has been active in the railway sector since 2008, with operations in Europe, Asia and the USA. The WERTHER Railway business unit designs, manufactures and maintains lifting systems compliant with European Safety Standards (ENs) for rail vehicles.

**MOBILE COLUMNS
FOR RAILWAY USE**

LTWF SERIES

WERTHER Railway mobile columns for railway use are ideal for lifting any type of railway vehicle (locomotives, electric railcars, bi-directional vehicles, passenger and freight carriages, and vehicles for the maintenance of equipment and of power lines, railway turntable ladders, etc.). They can meet the needs of any type of rail vehicle maintenance and repair shop.

Benefits of LTWF-series mobile columns:

Safety: Our mobile columns are compliant with the most recent European safety standards, both in terms of their construction (EN 1493:2010) and of their control systems (EN 13849-1). Their steel structures have wide and appropriate safety margins and are equipped with redundancy systems, making them "Performance Level 'D'" compliant as per EN 13849-1 and thus ensuring absolute operator safety, both when manoeuvring and when servicing vehicles.



Ease of Use: The control system, consisting of a wired remote control with a touchscreen, ensures:

- The simple, flawless and safe execution of every operation
- That all operations being performed are displayed and the operator is informed of any problems by means of user-friendly and easy-to-understand graphics



Ease of movement: Our mobile columns are equipped with a transpallet-type system of movement, which makes them easy to move and offers excellent manoeuvrability, even in tight spaces.

System modularity: Each lifting system can be divided into modules consisting of a minimum of four mobile columns, making it possible to create a system consisting of two or more separate lifting groups, up to a maximum of 32 columns.
(see following page)



Remote assistance: all WERTHER Railway lifting systems are equipped with:

- A system for detecting faults in real time (part, fault type, location)
- The ability to connect in real time to our Assistance Centre for verification and resolution of problems
- Safe emergency lowering during any use situation

The portable Polar remote control can be connected to any of the columns in use, automatically transforming it into the system's command column. The remote control is equipped with a touchscreen with a user-friendly interface, enabling the operator to constantly monitor:

- All parameters of operation (height reached, alignment and synchronism, etc.)
- Any alerts
- Any error messages, their causes and their exact locations



**MOBILE COLUMNS
FOR RAILWAY USE**

LTWE SERIES

The system's modularity allows for extremely flexible options in terms of set-up and use. A lifting system consisting of 16 mobile columns, for instance, can be used as a single system, as two 8-column systems or as up to a maximum of 4 separate groups of 4 columns each. In such a case, the groups can be used separately by hooking up multiple POLAR control units.

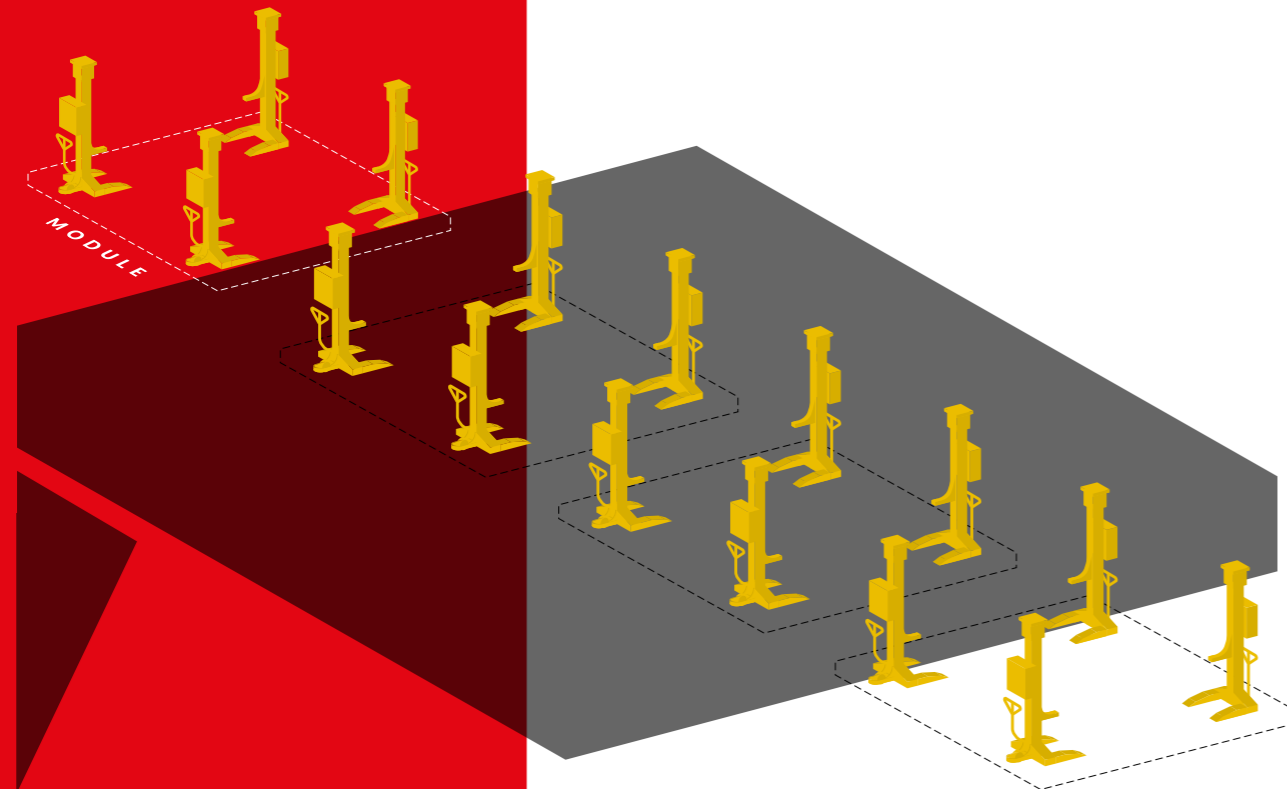

TECHNICAL DATA

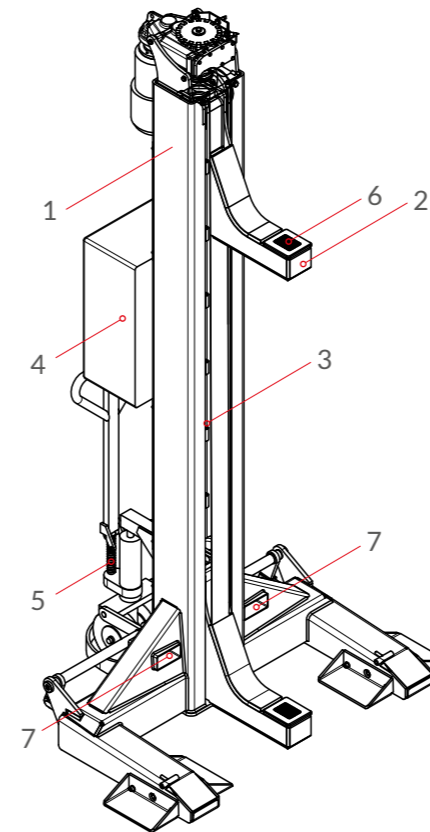

LTWE SERIES MODELS (basic series)*

Name	60	85	125	150	160	200
Capacity in tons	6	8,5	12,5	15	16	20
Lifting/descent speed in mm/sec.	6	6	5	5,9	6	4,6
Weight of single column w/o load in kg.	320	400	530	630	920	1350
Motor power in kW	2,2	3	3	4	3	5,5
Operating temperature in C°	-10°C to +50°C					
Protection rating	≥ IP54					
Operating environment	Indoor					

*other models and loading capacities upon specific request

- 1) Load-bearing frame
- 2) Load-support bracket with vehicle grip plate
- 3) Lifting assembly (worm / gear motor)
- 4) Secondary distribution switchboard (data and drive system)
- 5) Transpallet-type system of movement
- 6) Grip plate with contact-activated load sensors
- 7) Rapid transport slots (for forklift)

**from 4 to 32
Columns**

**from 6 to 20
Tons per Columns**





Via F. Brunelleschi, 12 - 42124 Cadè (RE) Italy
Tel. +39 0522 9431 +39 346 98 37 325 +39 98 37 443
Fax + 39 0522 941997 • E-mail: sales@wertherint.com
wertherint.com